



Installation Instructions

Craftsman Door Dentil Shelf



Tools Required

- Tape Measure
- 5mm Packers
- 3mm HSS Drill Bit
- Screws 4.5mm x 30mm
- Alcohol Wipes
- VHB Tape 2mm thick x 5mm wide (3M 4219P)
- Clamps x 2
- Screw Driver



1 Mark the centre of the midrail just above the bottom mouldings.



1a Mark the centre of the Dentil Shelf just below the central fixing screw hole.



2 Place the Dentil Shelf centrally onto the midrail and distance from cassette edge with the 5mm packers.

2a Mark the centre of the midrail just above the bottom mouldings. For solid doors mark a line parallel to the top mouldings 17mm below.

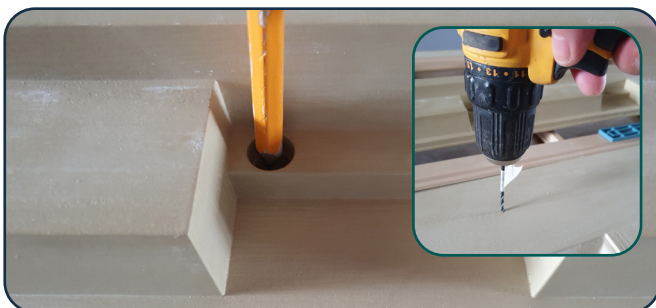

3 Mark x 3 the drill positions through the Dentil Shelf fixing holes onto the face of the slab.

3a Drill to a depth of 25mm using a 3mm HSS drill bit.



4 Clean the inner Dentil Shelf ledge with Alcohol wipes.

4a Apply VHB tape 2mm thick x 4mm wide.



Building Value
Into Building Products®

Installation Instructions

Craftsman Door Dentil Shelf



- 5** Clean the face of the slab midrail with Alcohol wipes before positioning the Dentil Shelf. Apply light pressure so not to damage paintwork.
- 5a** Carefully position the Dentil using the alignment guides from stages 1, 1A and 2.

NOTE: Accurate shelf location is critical because adhesive tape does not allow for re-positioning after contact with the panel surface.



- 6** Clamp in position for 20 minutes to achieve 50% bond strength. Ensure slab and Dentil Shelf surface are protected during the clamping process.

NOTE: Is not recommended to install the door until 100% bond strength is achieved which will take a further 24 hours.

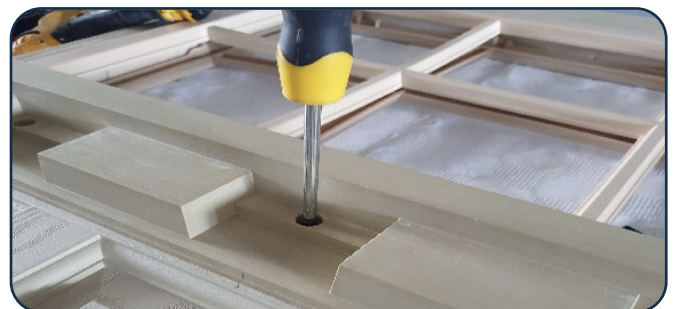

- 7** Fix at 3 x fixing points using 4.5 x 30mm screws. **DO NOT OVERTIGHTEN.** We recommend a hand tightening for this stage.

- 7a** Fit 3 x cover caps.

T: +44 (0)151 933 0299

E: enquiries@odleurope.com

www.odleurope.com

ODL Europe Ltd.
1 Brook Road
Bootle, Liverpool
L20 4XP
England